

FRIGO PENSILE CONSERVAZIONE CARNE

MEAT STORAGE AND DISPLAY COOLER



WALL MEAT 200 BLK

Frigo vetrina pensile per conservazione ed esposizione carne.

Meat storage and display cooler.



WALL MEAT 200 INOX

Frigo vetrina pensile per conservazione ed esposizione carne.

Meat storage and display cooler.



WALL MEAT 300 BLK

Frigo vetrina pensile per conservazione ed esposizione carne.

Meat storage and display cooler.



WALL MEAT 300 INOX

Frigo vetrina pensile per conservazione ed esposizione carne.

Meat storage and display cooler.

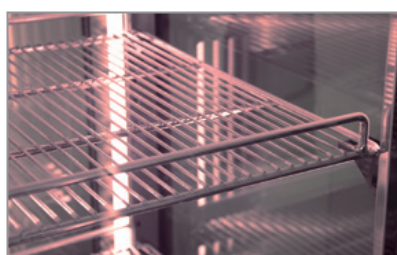

Interno in acciaio inox AISI 304
AISI 304 stainless steel inner liner



Maniglia integrata
Built-in handle



Staffa per appendamento a scomparsa
Hidden hanging bracket

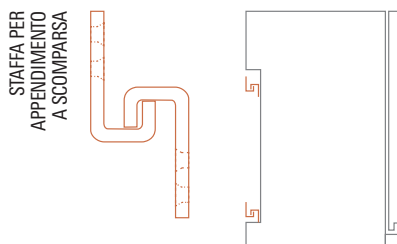
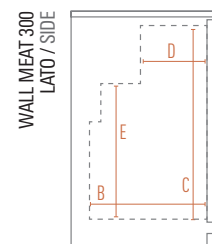
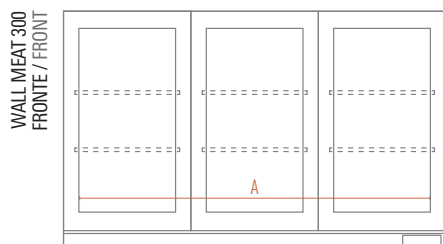
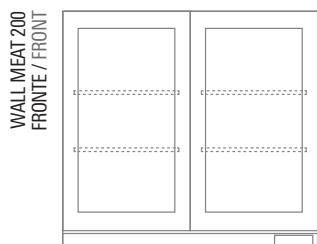

Dimensioni mm / Dimensions mm	WALL MEAT 200 BLK / INOX	WALL MEAT 300 BLK / INOX
Dimensioni Esterne (LxPxH) / External Dimensions (WxDxH)	900 x 565 x 852*	1350 x 565 x 852*
Dimensioni Imballo (LxPxH) / Packaging Dimensions (WxDxH)	920 x 620 x 1045	1440 x 630 x 1045
A - Larghezza / Width	810	1260
B - Profondità / Depth	375	375
C - Altezza / Height	705	705
D - Profondità Min. / Min. Depth	195	195
E - Altezza Min. / Min. Height	499	499

*Con piedini / with feet +30 mm

Caratteristiche Tecniche / Technical Features	WALL MEAT 200 BLK / INOX	WALL MEAT 300 BLK / INOX
Temperatura / Temperature Range	-2 °C / +10 °C	-2 °C / +10 °C
Umidità / Humidity	70 - 80%	70 - 80%
Classe Climatica / Climate Class	4	4
Volume Netto-Lordo / Net-Gross Volume	Lt. 146 / 195	Lt. 254 / 280
Superficie Esterna / Body	BLACK: Lamiera preverniciata con trattamento anticorrosione INOX: Acciaio AISI 304 spazzolato BLACK: Prepainted sheet with anticorrosion treatment INOX: 304 brushed stainless steel	BLACK: Lamiera preverniciata con trattamento anticorrosione INOX: Acciaio AISI 304 spazzolato BLACK: Prepainted sheet with anticorrosion treatment INOX: 304 brushed stainless steel
Superficie Interna / Inner Liner	Acciaio specchiato / Mirror Stainless Steel	Acciaio specchiato / Mirror Stainless Steel
Termostato / Thermostat	Elettronico / Electronic	Elettronico / Electronic
Smart Link WiFi Controllo remoto / Remote control	Optional	Optional
Rumorosità / Noise level	dB 60	dB 60
Spessore isolamento / Insulation thickness	mm 45	mm 45
Sbrinamento / Defrost	Automatico / Automatic	Automatico / Automatic
Illuminazione / Lighting	2 Led verticali + 1 orizzontale 2 Vertical led + 1 horizontal led	2 Led verticali + 1 orizzontale 2 Vertical led + 1 horizontal led
Mensole (LxP) / Shelves (WxD)	N° 4 - mm 395 x 336	Dx+Sx N° 4 - mm 399 x 340 Centrale / Central N° 2 - mm 446 x 440
Peso Netto-Lordo / Net-Gross Weight	Kg 83 / 101	Kg 99 / 119
Voltaggio / Voltage	V 220	V 220
Frequenza / Frequency	Hz 50	Hz 50
Refrigerante / Refrigerant	R600A	R600A
Assorbimento / Absorption	W 110	W 190
Consumo Energia / Energy Consumption	KwH/24H 1,32	KwH/24H 2,00